

# CHEYENNE PLAZA

1779-1791 S 8<sup>TH</sup> ST COLORADO SPRINGS, CO 80905



**4,200 SF** RETAIL SPACE AVAILABLE



**Colorado Springs  
Commercial**

# SITE PLAN



Available at **CHEYENNE PLAZA** on Colorado Springs' west side, this retail space offers prime exposure and easy access, drawing traffic from a dynamic mix of national and local tenants. Located near the prestigious Broadmoor Hotel, the site attracts a steady stream of affluent visitors and locals. The area boasts strong demographics with high-income households and a growing population, making it an ideal spot for retailers looking to thrive. With easy access and excellent visibility, this location provides everything needed for a successful business.



**LEASE RATE**  
**\$15-20.00 per RSF NNN**



**OPERATING EXPENSES**  
**\$4.11 per RSF (2024 Est.)**



**SHOPPING CENTER SIZE**  
**77,212 SF**



**MONUMENT SIGNAGE**  
**AVAILABLE**



**YEAR BUILT/RENOV.**  
**1987/2024**



**PARKING**  
**182 Spaces**



**ZONING**  
**OC CR**



**BUILDING SIGNAGE**  
**AVAILABLE**

# RETAIL SPACE FOR LEASE

## CHEYENNE PLAZA

1779-1791 S 8<sup>TH</sup> ST COLORADO SPRINGS, CO 80905



LEASE RATE

**\$15-20.00 per RSF NNN**



OPERATING EXPENSES

**\$4.11 per RSF (2024 Est.)**

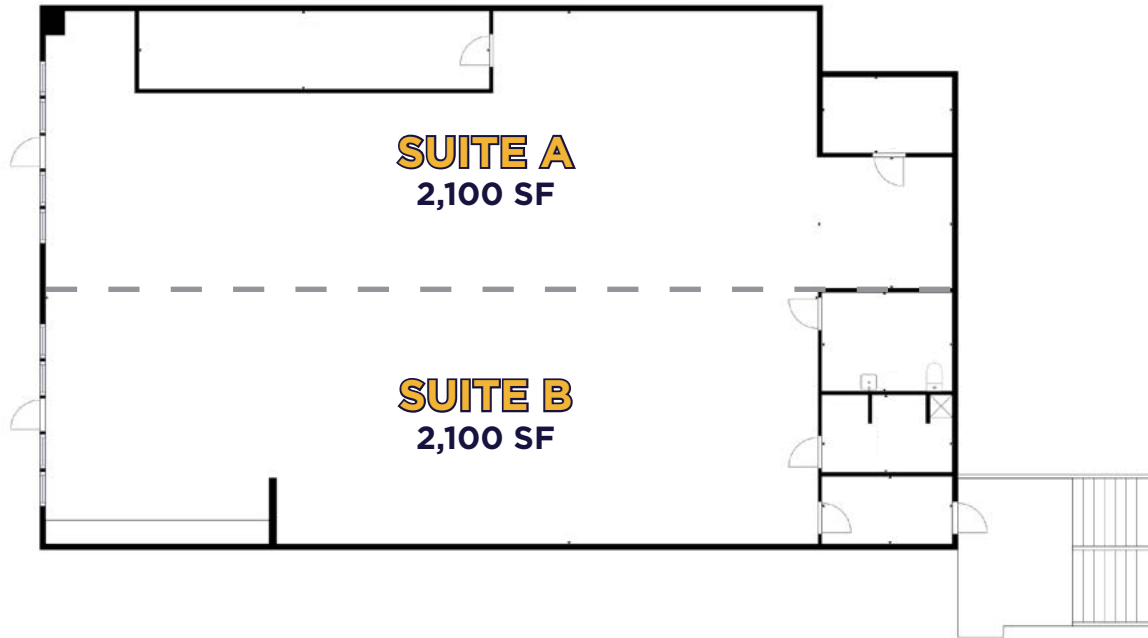

**SUITE 1791 A & B**

**4,200 SF AVAILABLE**

\*DIVISIBLE TO 2,100 SF



# DEMOGRAPHICS



## HOUSEHOLDS

1 MILE	3 MILES	5 MILES
4,869	30,241	74,843



## POPULATION

1 MILE	3 MILES	5 MILES
10,176	65,688	176,532



## AVERAGE HOUSEHOLD INCOME

1 MILE	3 MILES	5 MILES
\$88,574	\$90,634	\$83,686

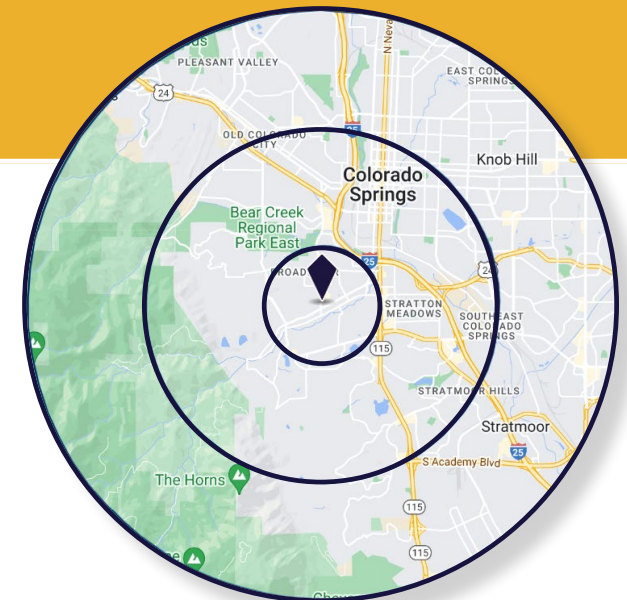



## FOR MORE INFORMATION, PLEASE CONTACT:

**DAN RODRIGUEZ**  
 +1 719-418-4068  
 dan@coscommercial.com

**PATRICK KERSCHER**  
 +1 719-418-4065  
 patrick@coscommercial.com



**Colorado Springs  
 Commercial**

©2024 Cushman & Wakefield. All rights reserved. The information contained in this communication is strictly confidential. This information has been obtained from sources believed to be reliable but has not been verified. NO WARRANTY OR REPRESENTATION, EXPRESS OR IMPLIED, IS MADE AS TO THE CONDITION OF THE PROPERTY (OR PROPERTIES) REFERENCED HEREIN OR AS TO THE ACCURACY OR COMPLETENESS OF THE INFORMATION CONTAINED HEREIN, AND SAME IS SUBMITTED SUBJECT TO ERRORS, OMISSIONS, CHANGE OF PRICE, RENTAL OR OTHER CONDITIONS, WITHDRAWAL WITHOUT NOTICE, AND TO ANY SPECIAL LISTING CONDITIONS IMPOSED BY THE PROPERTY OWNER(S). ANY PROJECTIONS, OPINIONS OR ESTIMATES ARE SUBJECT TO UNCERTAINTY AND DO NOT SIGNIFY CURRENT OR FUTURE PROPERTY PERFORMANCE.