



CUSHMAN &  
WAKEFIELD

Colorado Springs  
Commercial

# Adobe Court Business Park

3302-3372 ADOBE COURT COLORADO SPRINGS, CO 80907

LEASE RATE:	\$11.50/SF/YR NNN
NNN:	\$3.24/SF (2024 Est.)
CLEAR HEIGHT:	18'
DOORS:	(2) 10'x12' Drive-In Doors
PARKING:	1/1,000 RSF
ZONING:	M-1
SIGNAGE:	On building signage available





# Floor Plan

**SUITE 3330**  
7,000 SF AVAILABLE

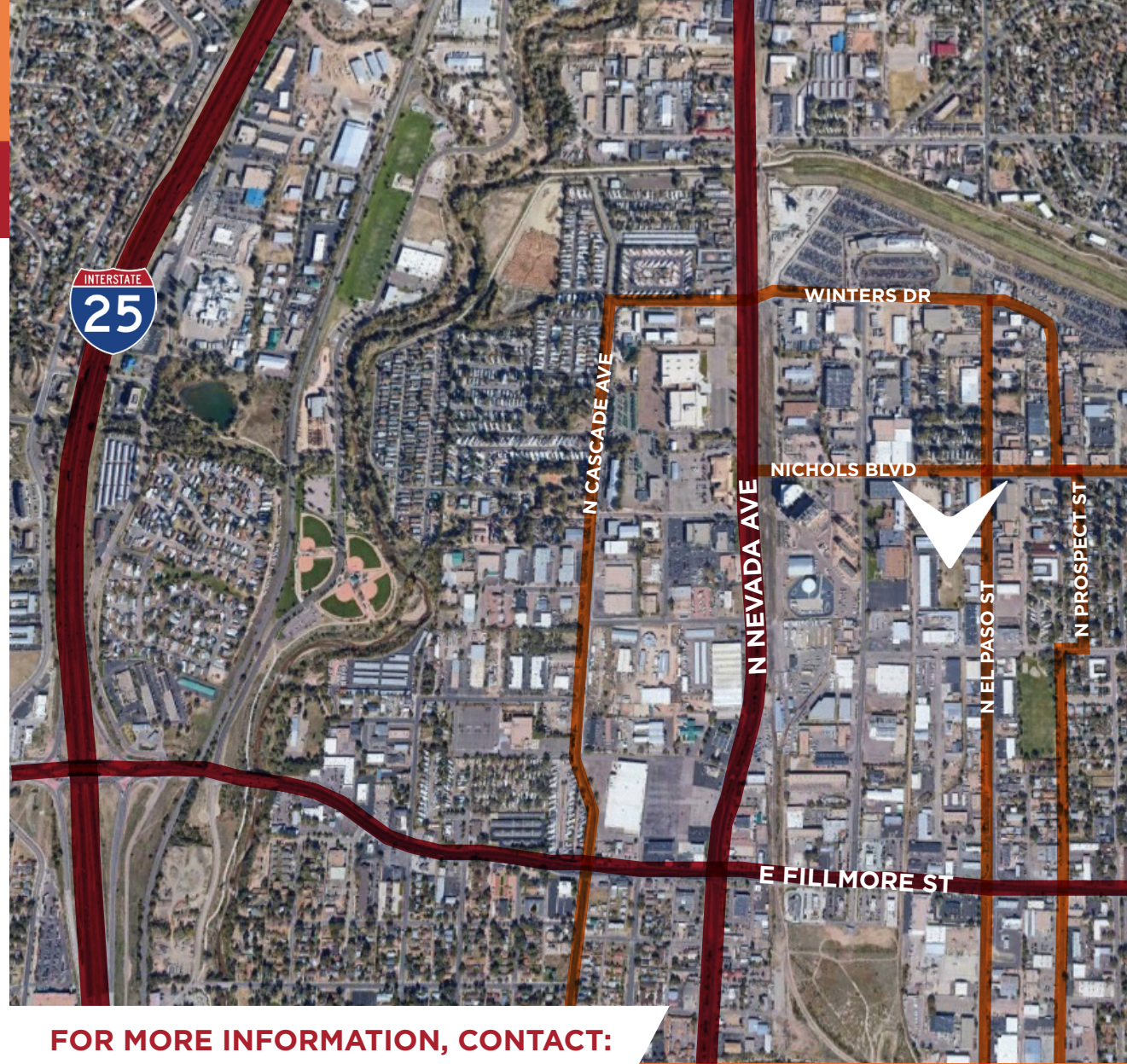
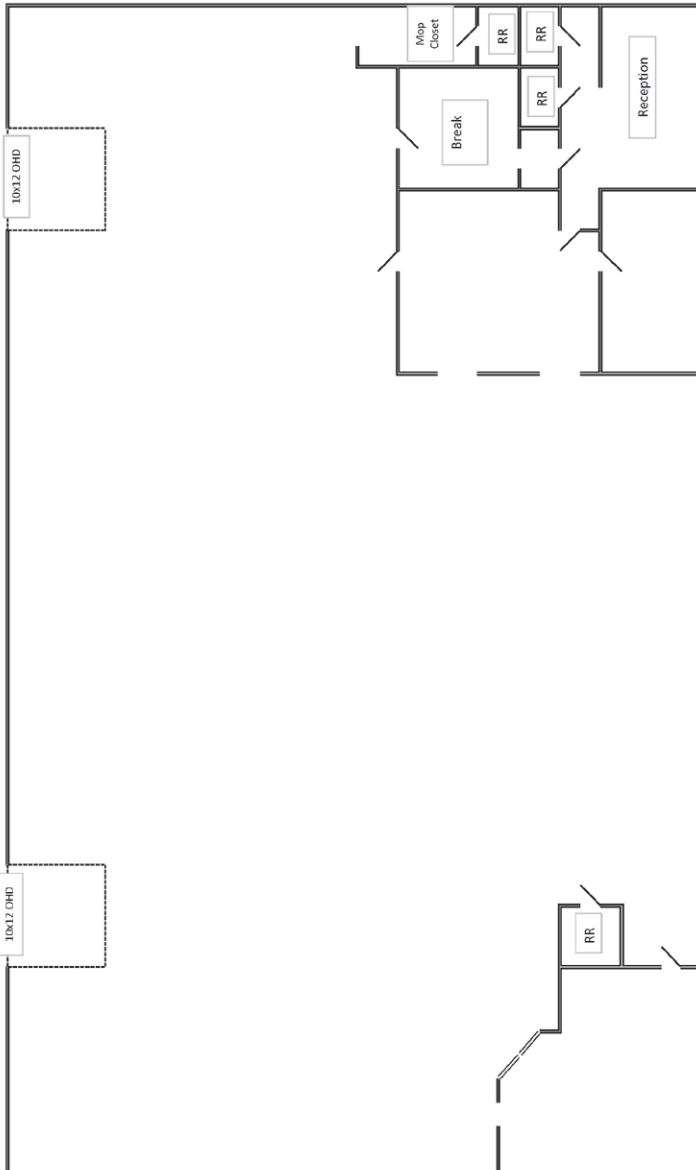

**FOR MORE INFORMATION, CONTACT:**



**CUSHMAN & WAKEFIELD**

**Colorado Springs  
Commercial**

**AARON HORN**

Sr, Managing Director

+1 719 418 4070

ahorn@coscommercial.com

**HEATHER MAURO-MCKEEN**

Director

+1 719 418 4062

hmauro@coscommercial.com

©2024 Cushman & Wakefield. All rights reserved. The material in this presentation has been prepared solely for information purposes, and is strictly confidential. Any disclosure, use, copying or circulation of this presentation (or the information contained within it) is strictly prohibited, unless you have obtained Cushman & Wakefield's prior written consent. The views expressed in this presentation are the views of the author and do not necessarily reflect the views of Cushman & Wakefield. Neither this presentation nor any part of it shall form the basis of, or be relied upon in connection with any offer, or act as an inducement to enter into any contract or commitment whatsoever. NO REPRESENTATION OR WARRANTY IS GIVEN, EXPRESS OR IMPLIED, AS TO THE ACCURACY OF THE INFORMATION CONTAINED WITHIN THIS PRESENTATION, AND CUSHMAN & WAKEFIELD IS UNDER NO OBLIGATION TO SUBSEQUENTLY CORRECT IT IN THE EVENT OF ERRORS.