



CUSHMAN &
WAKEFIELD

Colorado Springs
Commercial

305 SOUTH ROCKRIMMON BLVD

COLORADO SPRINGS, CO

CLASS A OFFICE FOR LEASE



305 SOUTH ROCKRIMMON BLVD

305 SOUTH ROCKRIMMON is a unique opportunity to lease up to 74,079 square feet of office space in Colorado Springs' northwest submarket. The building has a progressive design and is situated on a beautiful 47-acre site with modern features and an amenity package that is unparalleled in the office market. Ideally located in close proximity to numerous resources and easy access to I-25 with plentiful parking for your team.



ON-SITE FITNESS
CENTER



CLASS A
FINISHES
THROUGHOUT



CONFERENCE
AND TRAINING
ROOM

BUILDING DETAILS



295,562 SF
Building Size



74,079 RSF
Space Available



34,802 RSF
Max Contiguous



2
Stories



1982/2023
Y.O.C.



\$21.00/RSF FSG
Starting Lease Rate



Negotiable
Tenant Improvements



Up to 6.00/1,000 RSF
Parking Ratio



FIRST FLOOR

Fitness Center

Common Shipping and Receiving / Loading Dock

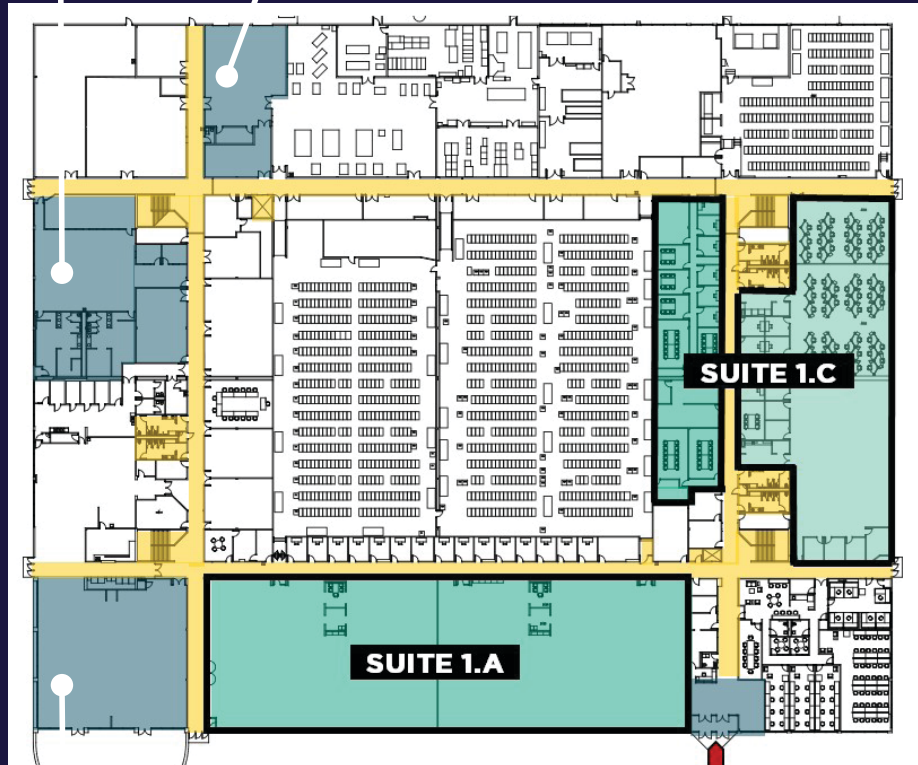

SUITE 1A
20,675 RSF

SUITE 1C
18,602 RSF

305 SOUTH ROCKRIMMON BLVD

FLOORPLAN KEY

- AVAILABLE
- COMMON CORRIDORS
- COMMON AMENITIES
- ENTRANCE

Dining Room Seating/Large Meeting Space

SECOND FLOOR

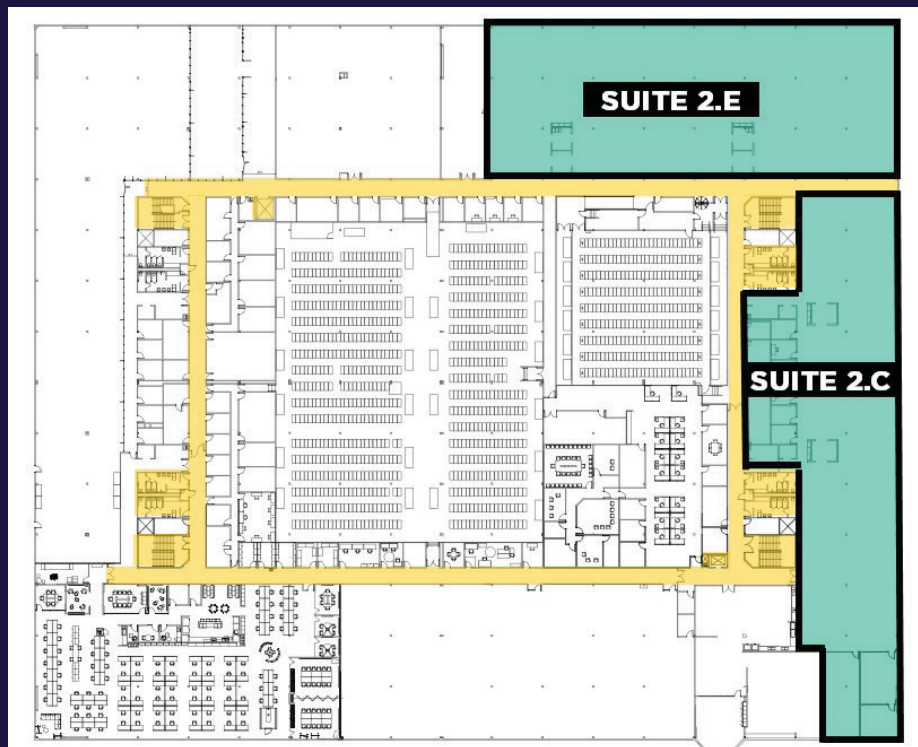

SUITE 2C
17,252 RSF

SUITE 2E
17,550 RSF



1 MILE

8,571

3 MILES

48,044

5 MILES

131,429



1 MILE

3,589

3 MILES

20,335

5 MILES

55,118



1 MILE

\$118,787

3 MILES

\$110,032

5 MILES

\$100,280

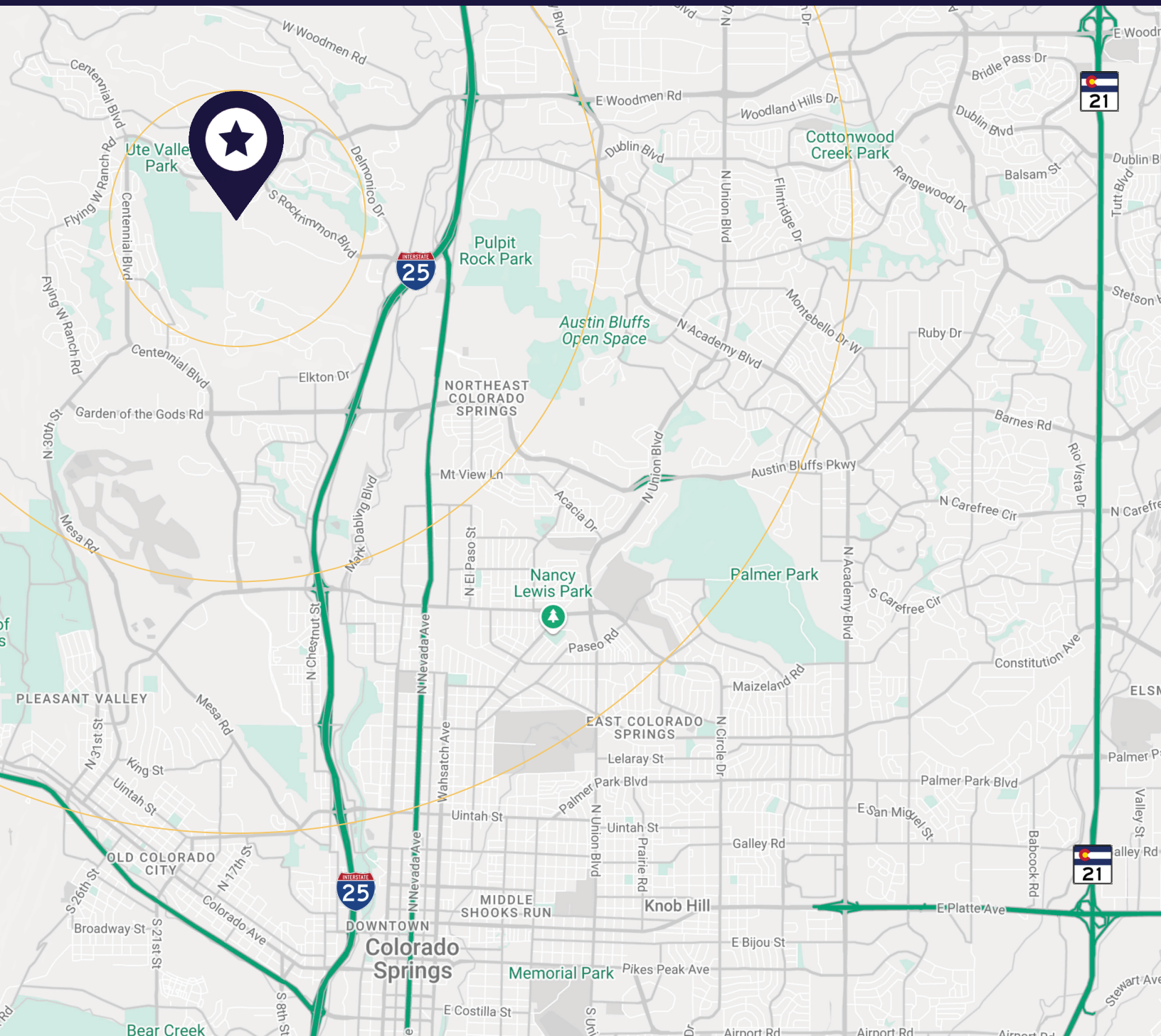

305 SOUTH ROCKRIMMON BLVD

NEARBY RESTAURANTS



**CUSHMAN &
WAKEFIELD**

**Colorado Springs
Commercial**

GRANT SEANOR

Direct: +1 719 418 4071
Mobile: +1 330 412 2297
gseanor@coscommercial.com

PETER SCOVILLE

Direct: +1 719 418 4063
Mobile: +1 719 330 8339
pscoville@coscommercial.com

GREG PHANEUF

Direct: +1 719 418 4064
Mobile: +1 719 339 9062
gphaneuf@coscommercial.com

Colorado Springs Commercial
90 South Cascade Ave, Suite 1150 Colorado Springs, CO 80903
+1 719 634 1500 • coscommercial.com

©2024 Cushman & Wakefield. All rights reserved. The information contained in this communication is strictly confidential. This information has been obtained from sources believed to be reliable but has not been verified. NO WARRANTY OR REPRESENTATION, EXPRESS OR IMPLIED, IS MADE AS TO THE CONDITION OF THE PROPERTY (OR PROPERTIES) REFERENCED HEREIN OR AS TO THE ACCURACY OR COMPLETENESS OF THE INFORMATION CONTAINED HEREIN, AND SAME IS SUBMITTED SUBJECT TO ERRORS, OMISSIONS, CHANGE OF PRICE, RENTAL OR OTHER CONDITIONS, WITHDRAWAL WITHOUT NOTICE, AND TO ANY SPECIAL LISTING CONDITIONS IMPOSED BY THE PROPERTY OWNER(S). ANY PROJECTIONS, OPINIONS OR ESTIMATES ARE SUBJECT TO UNCERTAINTY AND DO NOT SIGNIFY CURRENT OR FUTURE PROPERTY PERFORMANCE.