

# RESEARCH

8540 Scarborough Drive  
Colorado Springs, CO



**CLASS A MEDICAL OFFICE  
FOR LEASE**



**CUSHMAN &  
WAKEFIELD**

**Colorado Springs  
Commercial**

# RESEARCH

8540 Scarborough Drive  
Colorado Springs, CO



## BUILDING DETAILS

### LOCATION:

**Just west of the southwest corner of  
Powers Blvd & Research Pkwy**

### BUILDING SIZE:

**42,770 RSF**

### LEVELS:

**3**

### AVAILABLE SPACE:

**Suite 200: 3,086 RSF**

### LEASE RATE:

**Contact Broker**

### EXPENSES:

**\$14.65 per RSF (2026 estimate)**

### PARKING RATIO:

**5 spaces per 1,000 RSF**

### YEAR CONSTRUCTED:

**2008/2021**

OWNED & MANAGED BY  
**HEALTHCARE  
REALTY**



# 2<sup>ND</sup> FLOOR SUITE 200 - 3,086 RSF

# BUILDING AMENITIES

Newly remodeled common areas

Close proximity to both  
UCHealth Memorial North/  
Children's Hospital & St. Francis  
Medical Center

Monument, lobby, and directory  
signage available

Central to Colorado Springs'  
greatest population growth

## JOIN

Select Physical Therapy

UCHealth

Elevated Family Care

Ridgeview Optometry

SoCO Smiles Orthodontics

Ultimate Image

Immersive Health Management

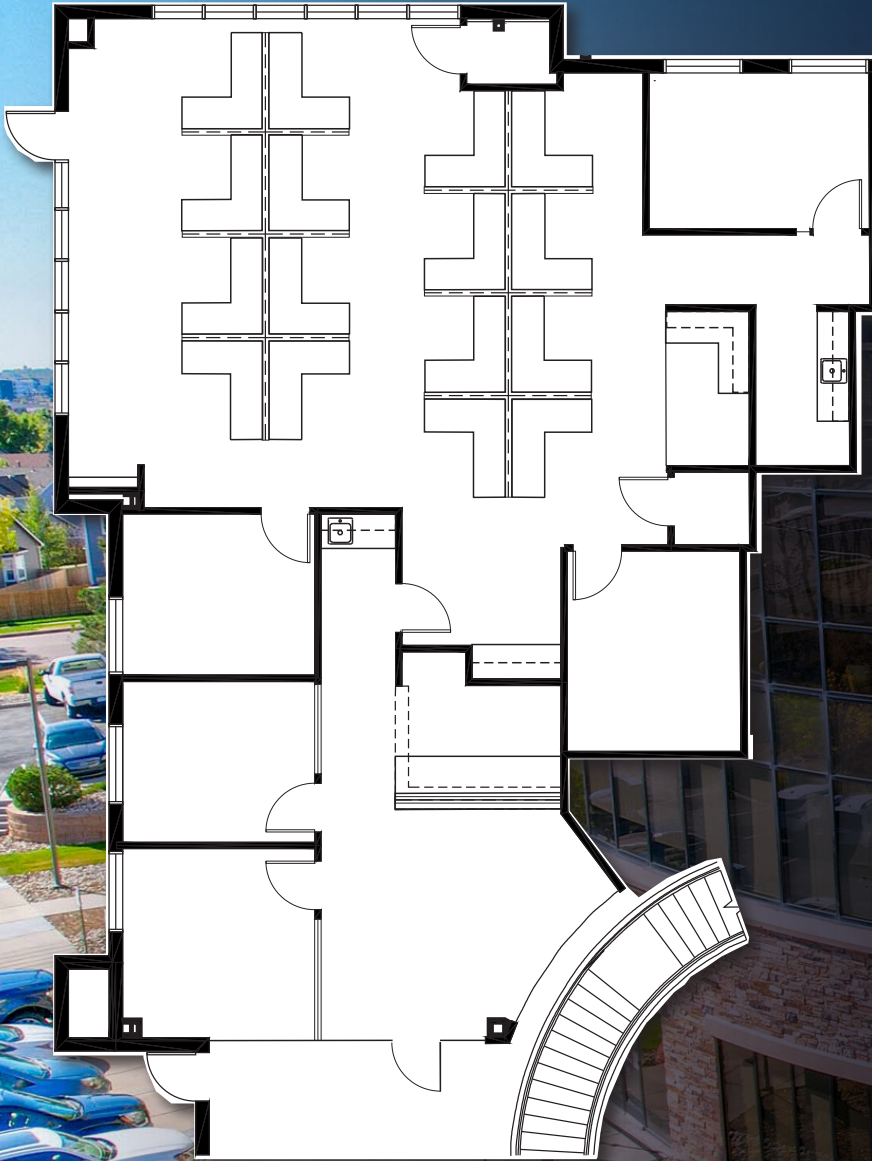

UCHealth Interquest

INTERQUEST PKWY



Centura Health



St. Francis – Interquest  
Orthopedic & Spine  
72 beds



VOYAGER PKWY

Children's Hospital



UCHealth Memorial North



BRIARGATE PKWY

POWERS BLVD

RESEARCH  
RESEARCH PKWY

WOODMEN RD

St. Francis Medical Center



### MEDICAL DRIVE TIMES

UCHealth Memorial North/Children's Hospital  
5 Minutes

St. Francis Medical Center  
6 Minutes

UCHealth Interquest Medical Center  
10 Minutes

St. Francis-Interquest  
12 Minutes

UCHealth Grandview Hospital  
15 Minutes

Penrose St. Francis Main  
25 Minutes

Memorial Hospital  
25 Minutes

### DEMOGRAPHICS

	1 MILE	3 MILE	5 MILE
2024 Population	15,149	95,024	197,331
2024 Households	4,931	33,752	73,106
AVG. HH Income	\$157,980	\$140,615	\$129,513

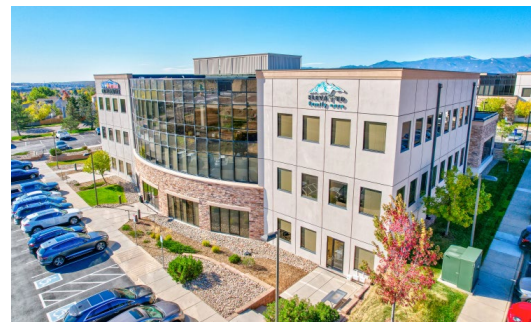

**PETER SCOVILLE**

Principal

+1 719 418 4063

pscoville@coscommercial.com

**GREG PHANEUF**

Principal

+1 719 418 4064

gphaneuf@coscommercial.com

**KATHY MANCHESTER**

Associate Broker

+1 719 418 4067

kmanchester@coscommercial.com



Colorado Springs  
Commercial

90 S Cascade Avenue, Suite 1150  
Colorado Springs, CO 80903

©2026 Cushman & Wakefield. All rights reserved. The material in this presentation has been prepared solely for information purposes, and is strictly confidential. Any disclosure, use, copying or circulation of this presentation (or the information contained within it) is strictly prohibited, unless you have obtained Cushman & Wakefield's prior written consent. The views expressed in this presentation are the views of the author and do not necessarily reflect the views of Cushman & Wakefield. Neither this presentation nor any part of it shall form the basis of, or be relied upon in connection with any offer, or act as an inducement to enter into any contract or commitment whatsoever. NO REPRESENTATION OR WARRANTY IS GIVEN, EXPRESS OR IMPLIED, AS TO THE ACCURACY OF THE INFORMATION CONTAINED WITHIN THIS PRESENTATION, AND CUSHMAN & WAKEFIELD IS UNDER NO OBLIGATION TO SUBSEQUENTLY CORRECT IT IN THE EVENT OF ERRORS.