



CUSHMAN &
WAKEFIELD

Colorado Springs
Commercial

THE MARKETS AT

MESA RIDGE

6859 - 6925 MESA RIDGE PARKWAY, FOUNTAIN, CO 80817



6965 MESA RIDGE PKWY
#140: 1,100 SF AVAILABLE



THE MARKETS AT

MESA RIDGE

SITE PLAN

6859 - 6925 MESA RIDGE PARKWAY, FOUNTAIN, CO 80817



30,968 VPD



MESA RIDGE PKWY



FOUNTAIN MESA RD

Suite 6965 #140
1,100 SF
AVAILABLE

CROSS CREEK





**6965 MESA RIDGE PKWY
#140: 1,100 SF**

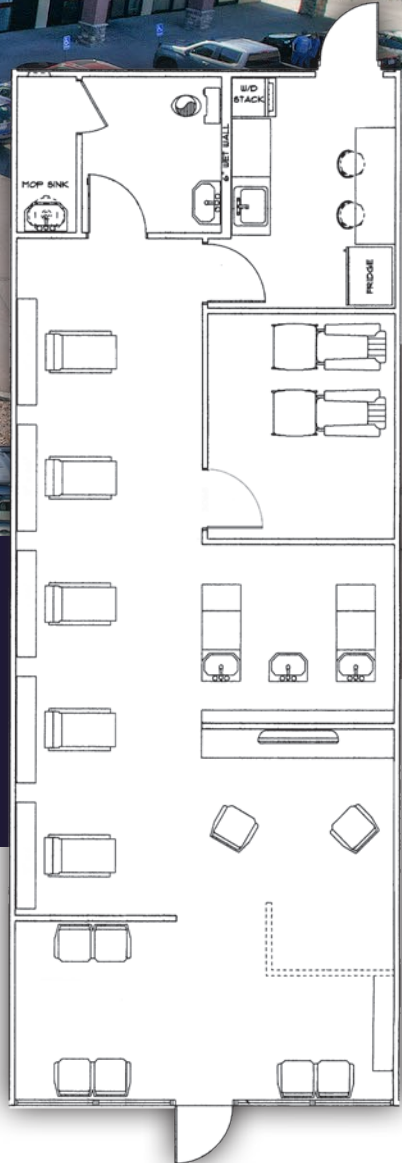

SUITE 140 AVAILABLE

LEASE RATE \$32.00 per PSF NNN

EXPENSES \$10.63 per RSF (2025 Est.)

IN-LINE SUITE 6965 MESA RIDGE PKWY #140: 1,100 SF

6965 MESA RIDGE PKWY #140

Former Salon Space
1,100 SF

THE MARKETS AT

MESA RIDGE

6859 - 6925 MESA RIDGE PARKWAY, FOUNTAIN, CO 80817

CUSHMAN & WAKEFIELD | Colorado Springs Commercial

PATRICK KERSCHER

Sr Managing Director

O: +1 719 418 4065

patrick@coscommercial.com

DAN RODRIGUEZ

Sr Managing Director

O: +1 719 418 4068

dan@coscommercial.com



Total Fort Carson
Population 74,814

DEMOGRAPHICS

	1 Mile	3 Mile	5 Mile
Population	12,828	47,301	88,240
Avg. HH Income	\$90,559	\$94,218	\$92,934
Households	4,326	15,649	28,179

TRAFFIC COUNTS

Fountain Mesa Rd at Mesa Rd	17,949 VPD
Fountain Mesa Rd at Mesa Ridge Pkwy	30,968 VPD
I-25 at Mesa Ridge Pkwy	36,185 VPD

©2025 Cushman & Wakefield. All rights reserved. The information contained in this communication is strictly confidential. This information has been obtained from sources believed to be reliable but has not been verified. NO WARRANTY OR REPRESENTATION, EXPRESS OR IMPLIED, IS MADE AS TO THE CONDITION OF THE PROPERTY (OR PROPERTIES) REFERENCED HEREIN OR AS TO THE ACCURACY OR COMPLETENESS OF THE INFORMATION CONTAINED HEREIN, AND SAME IS SUBMITTED SUBJECT TO ERRORS, OMISSIONS, CHANGE OF PRICE, RENTAL OR OTHER CONDITIONS, WITHDRAWAL WITHOUT NOTICE, AND TO ANY SPECIAL LISTING CONDITIONS IMPOSED BY THE PROPERTY OWNER(S). ANY PROJECTIONS, OPINIONS OR ESTIMATES ARE SUBJECT TO UNCERTAINTY AND DO NOT SIGNIFY CURRENT OR FUTURE PROPERTY PERFORMANCE.