

**SALE PRICE & LEASE RATE REDUCED**

SALE PRICE \$2,295,000 | LEASE RATE \$7.00/PSF NNN

24,450 SF ON  $\pm 2$  AC **FOR SALE**  
17,450 SF **FOR LEASE**



**LIGHTED  
SIGNAGE  
WITH I-25  
VISIBILITY**



**CUSHMAN &  
WAKEFIELD**

**Colorado Springs  
Commercial**

**4225-4231  
N ELIZABETH ST**

PUEBLO, CO 81008



# 24,450 SF BUILDING ON ±2 AC AVAILABLE FOR SALE OR LEASE

## LEASED SPACE

7,000 SF is currently leased to Sit Means Sit through June 30, 2026 leaving 17,450 SF available for buyer or tenant.

## AVAILABLE SPACE

The available space includes approximately 10,000 SF of warehouse/manufacturing space, 2,000 SF of showroom, and a 4,500 SF second-story office overlooking both. It features two 10'x12' overhead doors, ample power, and 1.5 acres of outdoor storage—half an acre behind the building and one acre in front with excellent visibility from I-25. Additionally, an existing tenant provides in-place income to help offset ownership costs.



**24,450 SF**  
BUILDING SIZE



**APPROX. 2 ACRES**  
SITE AREA



**B-3**  
ZONING



**05-130-45-001**  
PARCEL #



**20'**  
CLEAR HEIGHT



**600A 208V 3-PHASE**  
POWER



**(3) 10' x 12' OHD**  
TOTAL LOADING



**1999**  
YEAR BUILT



**\$2,295,000**  
~~**\$2,600,000**~~  
PURCHASE PRICE



**\$93.86/SF**  
PRICE PER SF



**\$40,180.88**  
TAXES (2024)



**17,450 SF**  
AVAILABLE SPACE



**\$7.00/RSF NNN**  
~~**\$8.00/RSF NNN**~~  
LEASE RATE



**\$2.50/SF**  
EXPENSES (2025 EST)

SALE

LEASE



**31,521 VPD**



# SITE PLAN



[Click Here to view floorplans for the Mezzanine & First Floor](#)



## FLOORPLAN

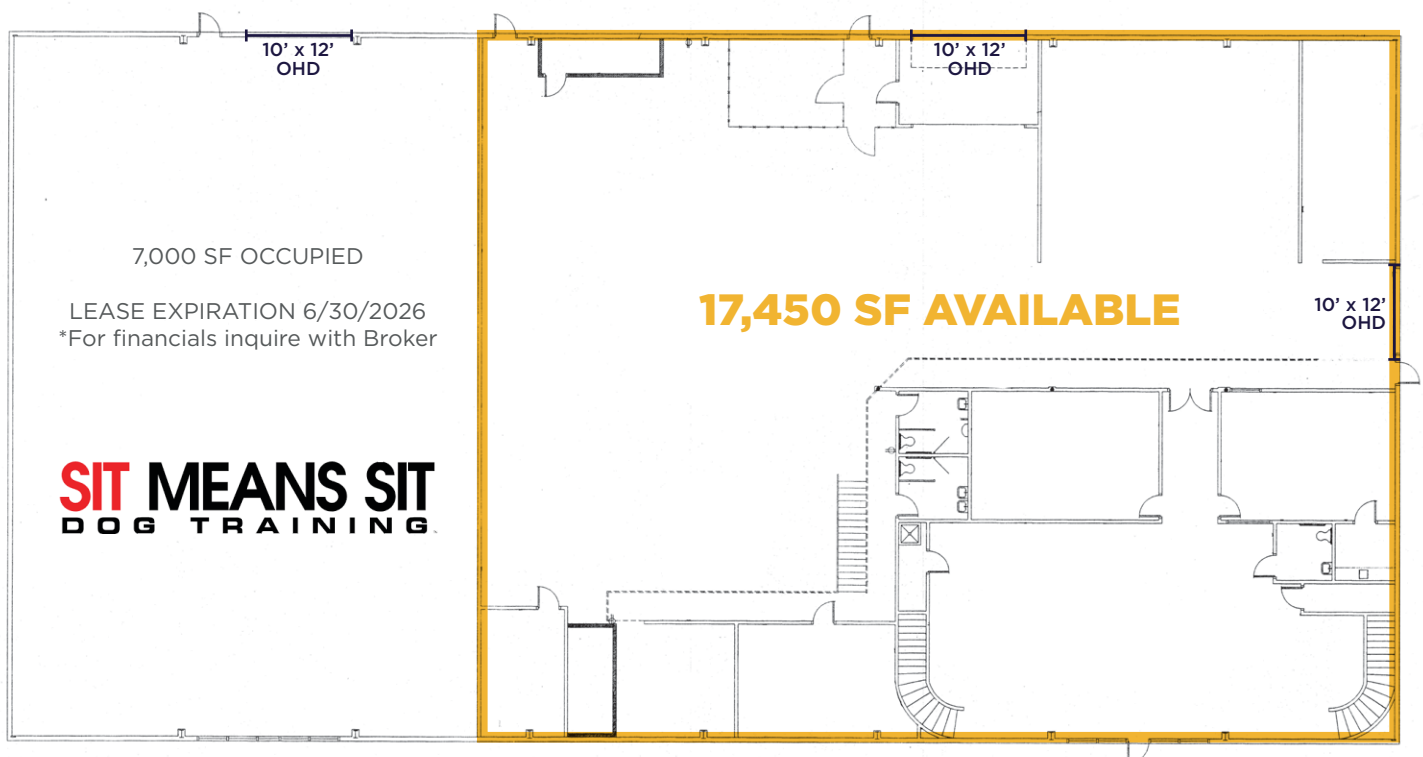





**FOR MORE INFORMATION, PLEASE CONTACT:**



**CUSHMAN &  
WAKEFIELD**

**Colorado Springs  
Commercial**

**AARON HORN**

Sr Managing Director

+1 719 418 4070

[ahorn@coscommercial.com](mailto:ahorn@coscommercial.com)

**HEATHER MCKEEN**

Director

+1 719 418 4062

[hmckeen@coscommercial.com](mailto:hmckeen@coscommercial.com)

©2025 Cushman & Wakefield. All rights reserved. The information contained in this communication is strictly confidential. This information has been obtained from sources believed to be reliable but has not been verified. NO WARRANTY OR REPRESENTATION, EXPRESS OR IMPLIED, IS MADE AS TO THE CONDITION OF THE PROPERTY (OR PROPERTIES) REFERENCED HEREIN OR AS TO THE ACCURACY OR COMPLETENESS OF THE INFORMATION CONTAINED HEREIN, AND SAME IS SUBMITTED SUBJECT TO ERRORS, OMISSIONS, CHANGE OF PRICE, RENTAL OR OTHER CONDITIONS, WITHDRAWAL WITHOUT NOTICE, AND TO ANY SPECIAL LISTING CONDITIONS IMPOSED BY THE PROPERTY OWNER(S). ANY PROJECTIONS, OPINIONS OR ESTIMATES ARE SUBJECT TO UNCERTAINTY AND DO NOT SIGNIFY CURRENT OR FUTURE PROPERTY PERFORMANCE.