



CUSHMAN &
WAKEFIELD

Colorado Springs
Commercial

PENROSE PAVILION

2312 N Nevada Avenue, Colorado Springs, 80917



Class A Medical Office | **15,084 SF FOR SUBLEASE**

SKY
BRIDGE TO
PENROSE
HOSPITAL



PENROSE PAVILION

BUILDING SIZE:	69,526 SF
STORIES:	4
SUBLEASE SPACE:	Suite 100: 15,084 SF
LEASE RATE:	Contact Broker
OPERATING EXPENSES:	\$15.33 per RSF (2026 estimate)
SUBLEASE TERM:	2/28/2030
PARKING RATIO:	5 per 1,000 RSF

- Class-A interior and finish
- Connected to Penrose Hospital and PENRAD Imaging through sky bridge
- LEED certified by the U.S. Green Building Council
- Secured/Electronic Keyed Entry
- Quick access to I-25
- Excellent patient parking ratio and demographics
- Wifi access
- Private physician parking
- Access to competitive patient population
- Join Rocky Mountain Cancer Center, LabCorp, Centura Breast Care Center
- Increased physician productivity and profitability with referral base

FLOORPLAN

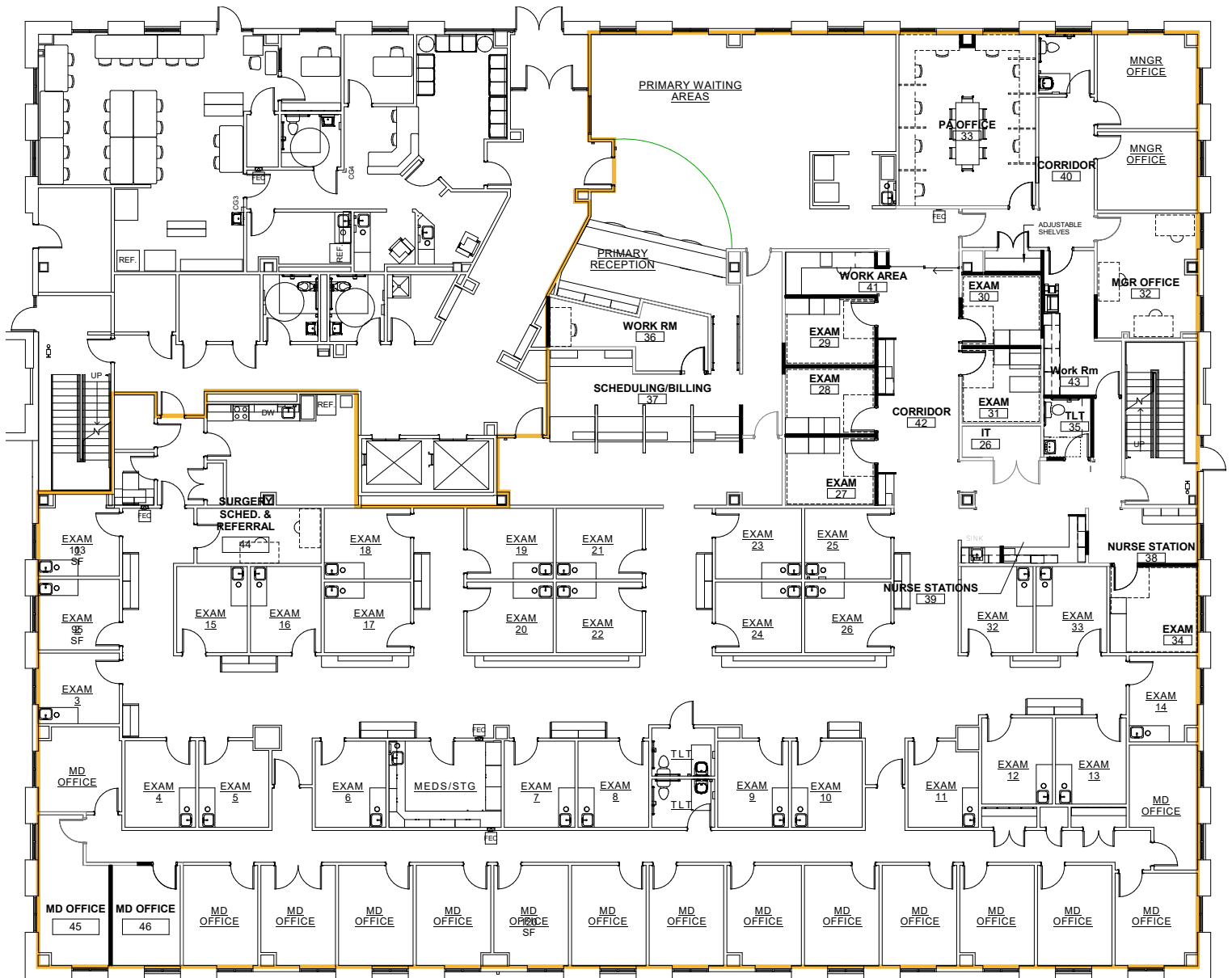

CommonSpirit
Penrose-St. Francis Hospital

SKY
BRIDGE



W FILLMORE ST

N NEVADA AVE

N CASCADE AVE



PENROSE PAVILION

E FONTANERO ST



**CUSHMAN &
WAKEFIELD**

**Colorado Springs
Commercial**

DAVID SCHROEDER

Managing Director

+1 719 418 4066

dschroeder@coscommercial.com

90 S Cascade Avenue, Suite 1150

Colorado Springs, CO 80903

+1 719 634 1500

coscommercial.com

©2026 Cushman & Wakefield. All rights reserved. The information contained in this communication is strictly confidential. This information has been obtained from sources believed to be reliable but has not been verified. NO WARRANTY OR REPRESENTATION, EXPRESS OR IMPLIED, IS MADE AS TO THE CONDITION OF THE PROPERTY (OR PROPERTIES) REFERENCED HEREIN OR AS TO THE ACCURACY OR COMPLETENESS OF THE INFORMATION CONTAINED HEREIN, & SAME IS SUBMITTED SUBJECT TO ERRORS, OMISSIONS, CHANGE OF PRICE, RENTAL OR OTHER CONDITIONS, WITHDRAWAL WITHOUT NOTICE, AND TO ANY SPECIAL LISTING CONDITIONS IMPOSED BY THE PROPERTY OWNER(S). ANY PROJECTIONS, OPINIONS OR ESTIMATES ARE SUBJECT TO UNCERTAINTY & DO NOT SIGNIFY CURRENT OR FUTURE PROPERTY PERFORMANCE.